

Straight clam connector with cap

for pneumatic systems of truck accessories

Specification

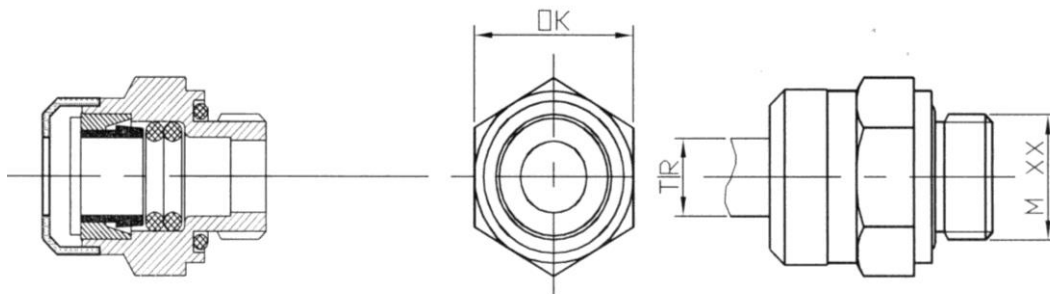

This connector with metric male thread is manufactured in sizes **10** and **15 mm**. It is designed for the John Guest Cartridge System in compliance with European standards including DIN 73378. The body is made out of brass.



Table of sizes:

Designation	TR-Tube OD [mm]	Wrench [mm]	Thread [mm]
M16 x 1,5 TR10	10	OK 22	M16 x 1,5
M22 x 1,5 TR10	10	OK 27	M22 x 1,5
M22 x 1,5 TR15	15	OK 27	M22 x 1,5

- **1,6 MPa** → max. working pressure between $-20 / +20$ °C

- **1 MPa** → max. working pressure at 65 °C